

Eagle's View Playground 5-12 - Project 117777-02-Opt 7 Phase 2
Unalaska, AK

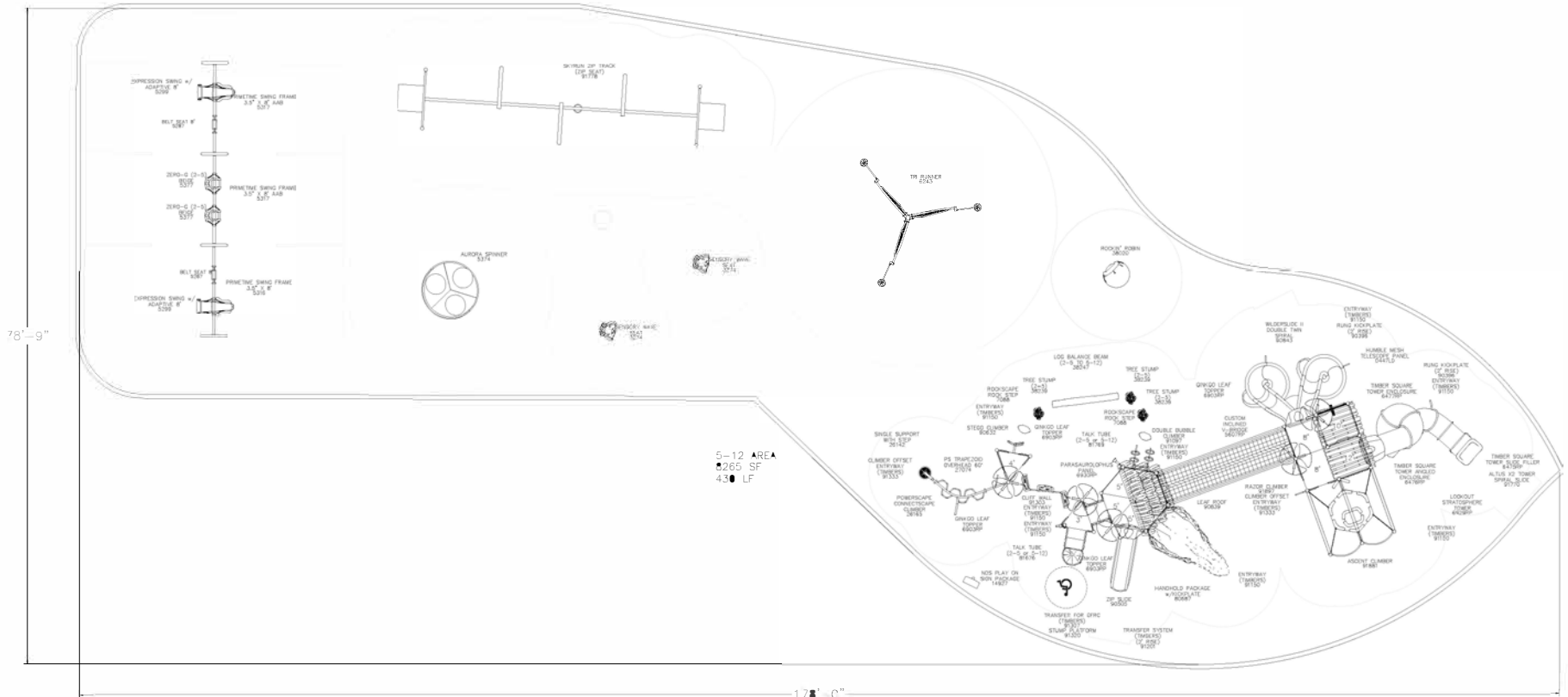



5-12 AREA
 265 SF
 43 LF



**Unalaska City School
 Eagle's View Elementary
 Unalaska, AK**
 Representative
 Great Western Recreation

SALES REP
 NANCY CASEY
 907-394-2577
 NANCY@GWPARK.COM

Total Elevated Play Components	10/14	Required	-
Total Elevated Play Components Accessible By Ramp	0/9	Required	5/7
Total Elevated Components Accessible By Transfer	7/17	Required	3/5
Total Accessible Ground Level Components Shown	4/4	Required	3/3

This play equipment is recommended for children ages
2-5/5-12

Minimum Area Required:
 Scale: -
 This drawing can be scaled only when in an 18" x 24" format

IMPORTANT: Soft resilient surfacing should be placed in the use zones of all equipment, as specified for each type of equipment, and at depths to meet the critical fall heights as specified by the U.S. consumer Product Safety Commission, ASTM standard F 1487 and Canadian Standard CAN/CSA-Z-614

Drawn By:
 EB
 Date:
 4/13/2026
 Drawing Name:
 107452-01-Opt 7 - PIT

Eagle's View Playground 5-12 - Project 117777-02-Opt 7 Phase 2
Unalaska, AK



**Eagle's View Playground 5-12 - Project 117777-02-Opt 7 Phase 2
Unalaska, AK**



**Eagle's View Playground 5-12 - Project 117777-02-Opt 7 Phase 2
Unalaska, AK**



**Eagle's View Playground 5-12 - Project 117777-02-Opt 7 Phase 2
Unalaska, AK**



**Eagle's View Playground 5-12 - Project 117777-02-Opt 7 Phase 2
Unalaska, AK**



Eagle's View Playground 5-12 - Project 117777-02-Opt 7 Phase 2
Unalaska, AK



**Eagle's View Playground 5-12 - Project 117777-02-Opt 7 Phase 2
Unalaska, AK**



Eagle's View Playground 5-12 - Project 117777-02-Opt 7 Phase 2
Unalaska, AK



**Eagle's View Playground 5-12 - Project 117777-02-Opt 7 Phase 2
Unalaska, AK**



**Eagle's View Playground 5-12 - Project 117777-02-Opt 7 Phase 2
Unalaska, AK**



Eagle's View Playground 5-12 - Project 117777-02-Opt 7 Phase 2
Unalaska, AK



**Eagle's View Playground 5-12 - Project 117777-02-Opt 7 Phase 2
Unalaska, AK**



**Eagle's View Playground 5-12 - Project 117777-02-Opt 7 Phase 2
Unalaska, AK**



**Eagle's View Playground 5-12 - Project 117777-02-Opt 7 Phase 2
Unalaska, AK**



Eagle's View Playground 5-12 - Project 117777-02-Opt 7 Phase 2
Unalaska, AK



**Eagle's View Playground 5-12 - Project 117777-02-Opt 7 Phase 2
Unalaska, AK**



**Eagle's View Playground 5-12 - Project 117777-02-Opt 7 Phase 2
Unalaska, AK**

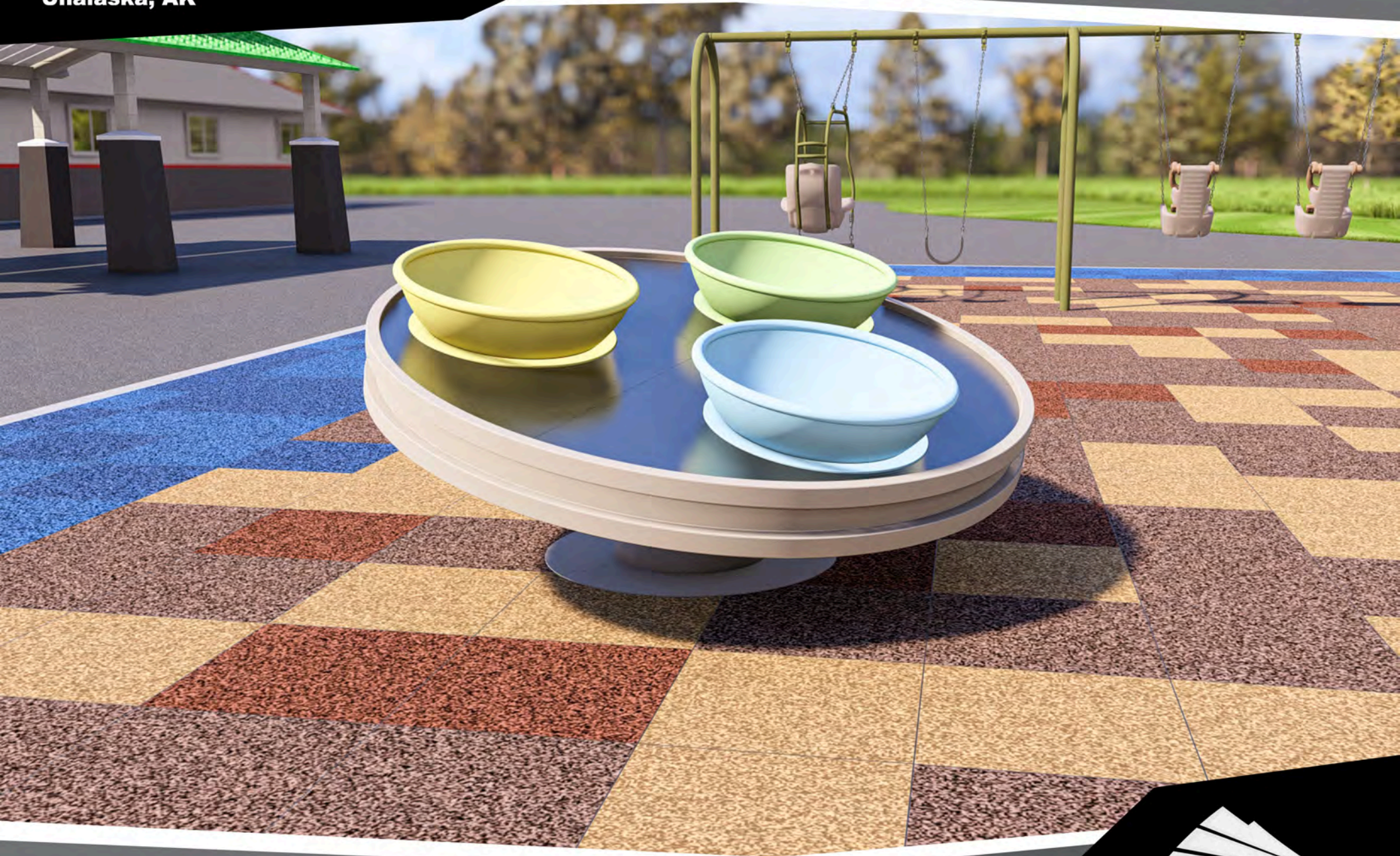

**Eagle's View Playground 5-12 - Project 117777-02-Opt 7 Phase 2
Unalaska, AK**



**Eagle's View Playground 5-12 - Project 117777-02-Opt 7 Phase 2
Unalaska, AK**



**Eagle's View ES Playground - Project 1074532-01-Opt 6
Unalaska, AK**



**Eagle's View ES Playground - Project 1074532-01-Opt 6
Unalaska, AK**



**Eagle's View ES Playground - Project 1074532-01-Opt 6
Unalaska, AK**

